

## APLIKACE



UNIVERSAL

## PARAMETRY



STEEL



ANTHRACITE



WHITE



SLOW



## BALENÍ



## OBSAH BALENÍ

1.

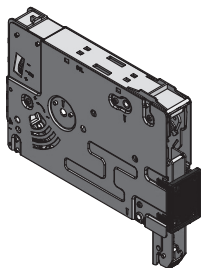

2.

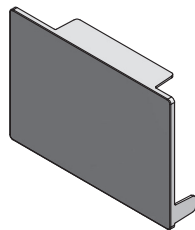

3.



5.



x 6

6.



x 8

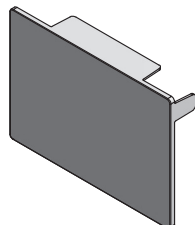
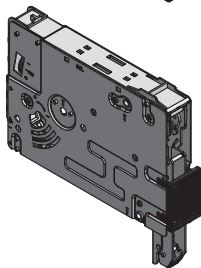

1. Výklop
2. Krytka x2
3. Čelní kování x2
4. Vrutky do výlopuného kování
5. Vrutky do čelního kování
6. Omezovač úhlu otevření

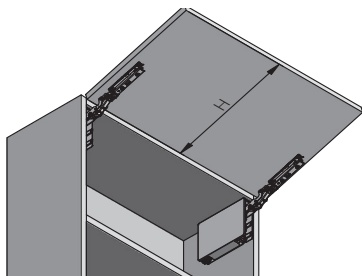

Obj. kod	Orientační výška dvířek	Koeficient F		Pružina	
11041	300 - 450 mm	500-1350	2-5	slabý	Bílá
11043	300 - 650 mm	1100-2250	2,8-7	střední	
11045	350 - 650 mm	2000-4050	4,5-10	silný	
11047	400 - 650 mm	3500-5200	8-12	extra silný	Šedá
11042	300 - 450 mm	500-1350	2-5	slabý	
11044	300 - 650 mm	1100-2250	2,8-7	střední	
11046	350 - 650 mm	2000-4050	4,5-10	silný	
11048	400 - 650 mm	3500-5200	8-12	extra silný	

Koeficient F = výška dvířek x hmotnost dvířek včetně dvojnásobné hmotnost úchtky v kg

PLANOVÁNÍ

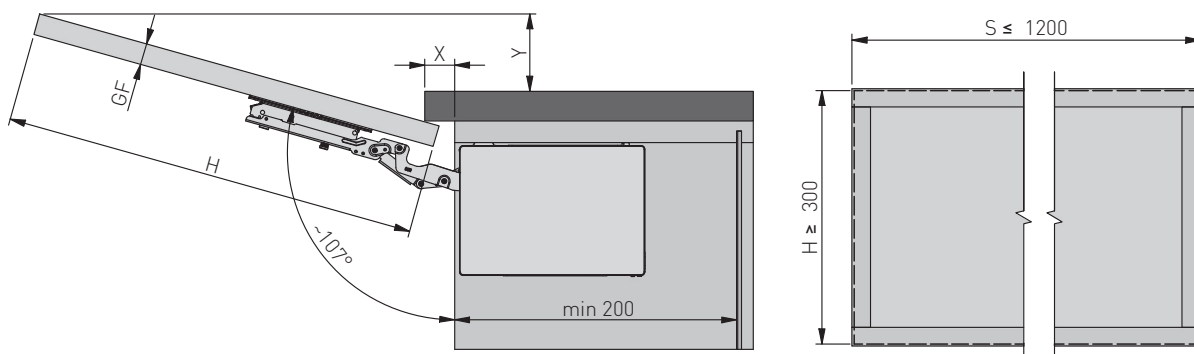

Úhel otevření dvířek	GF (mm)	X (mm)	Y (mm)
107°	16	70	Y=Hx0,29 - 6
	19	58	
	22	49	
	26	35	

GF – síla dvířek

Rozměry produktu

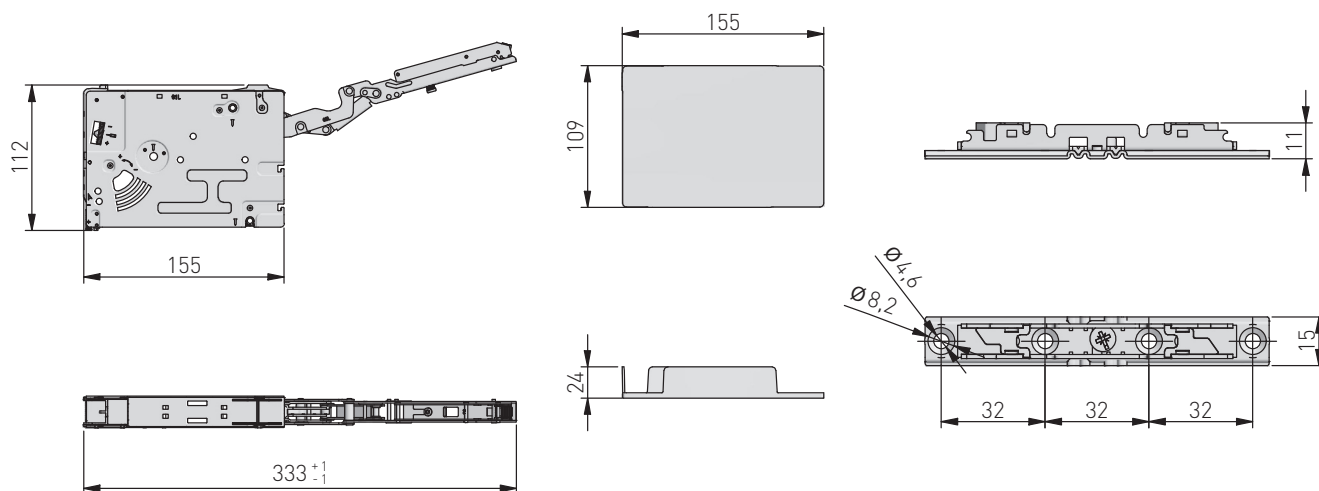

POZICE

Maximální úhel otevření

Minimální úhel aktivace

Pozor na zvedací rameno

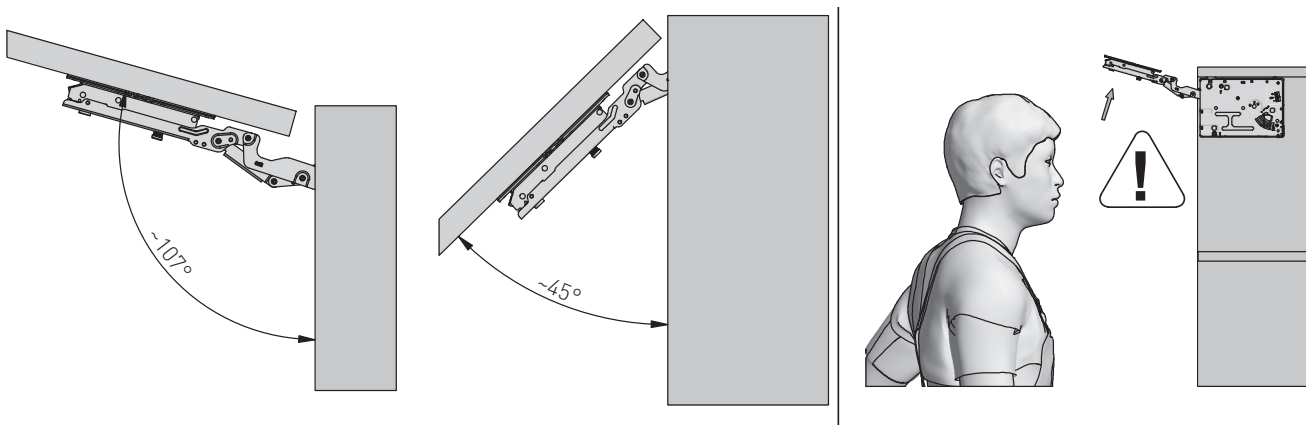

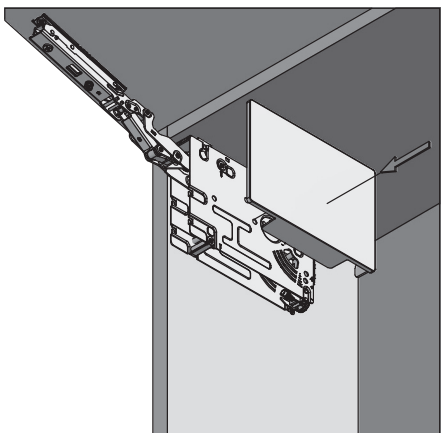
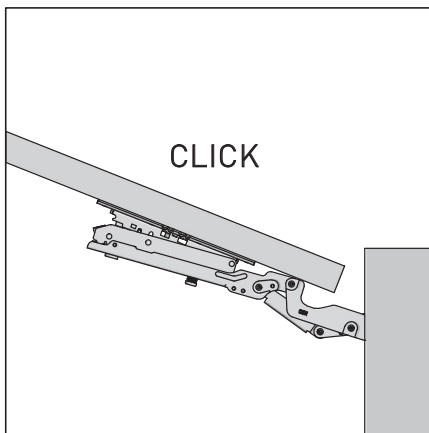
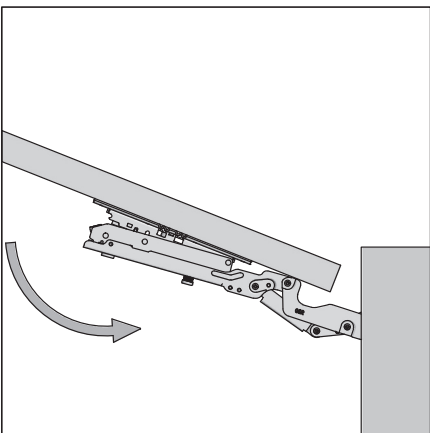
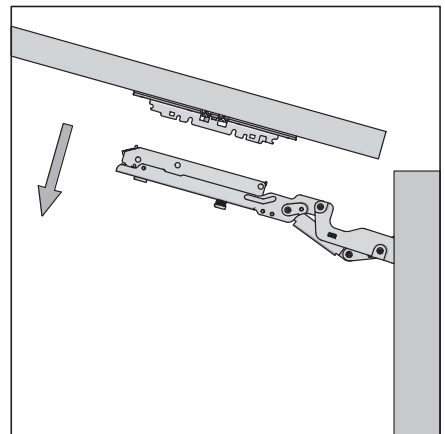
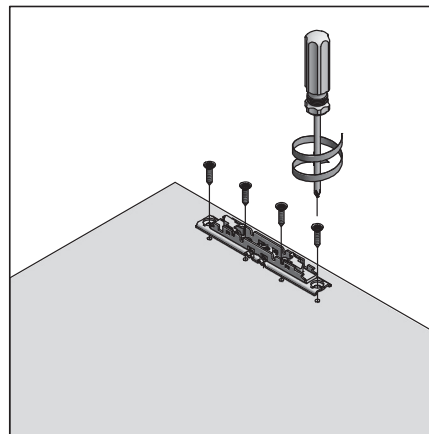
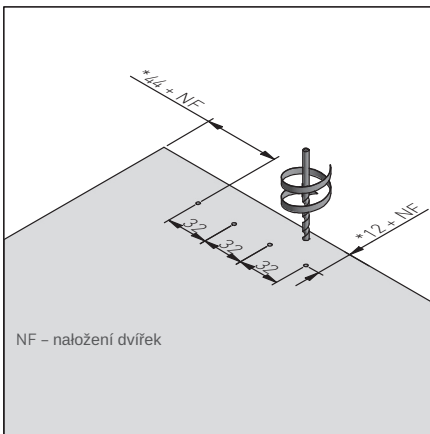
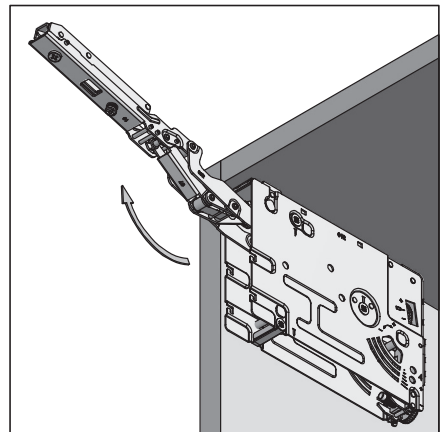
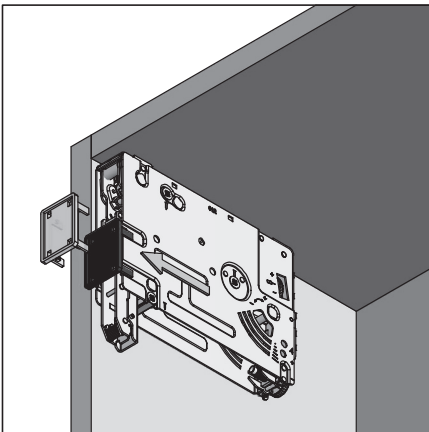
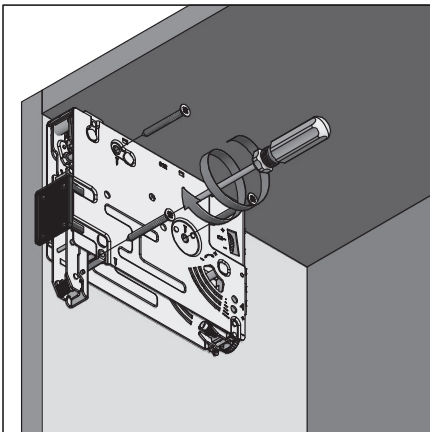
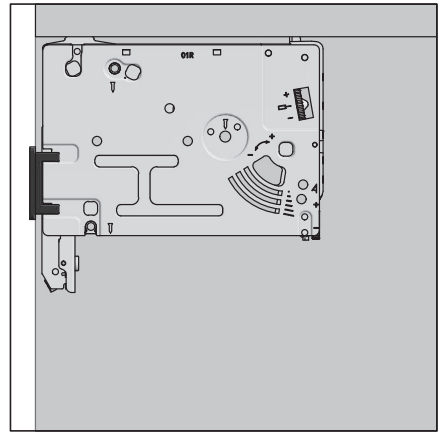
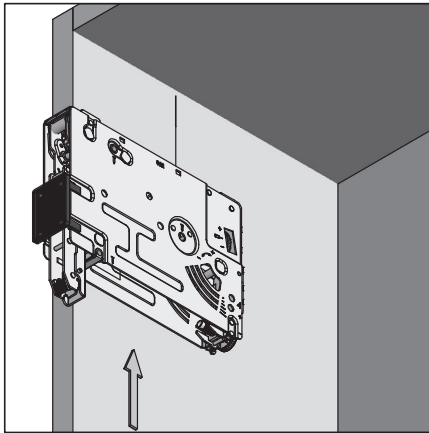
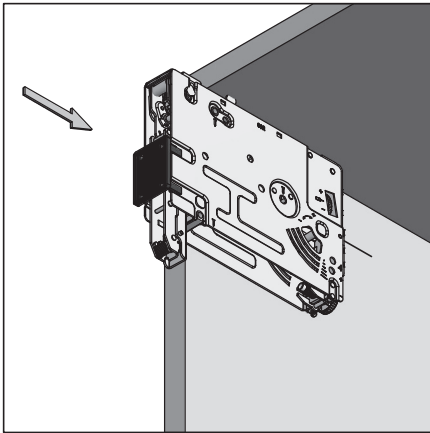

REGULACE A NASTAVENÍ

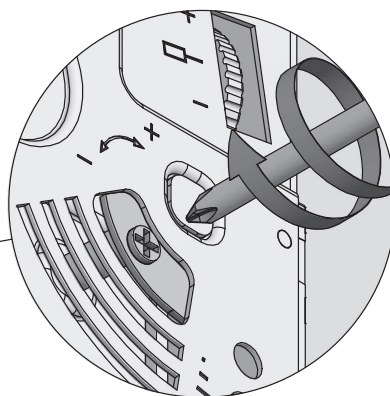
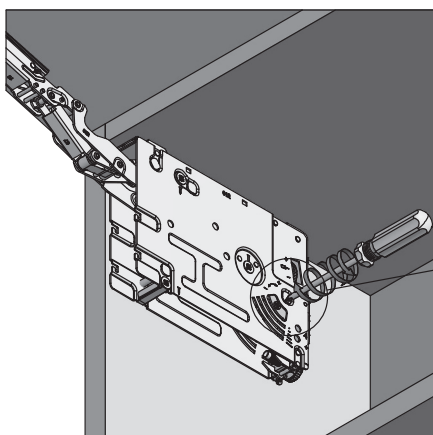
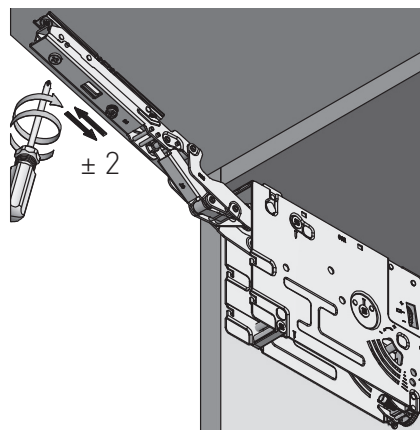
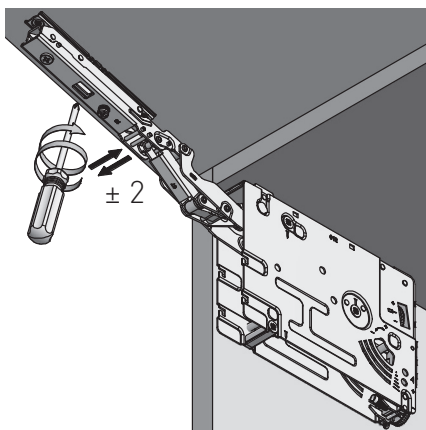
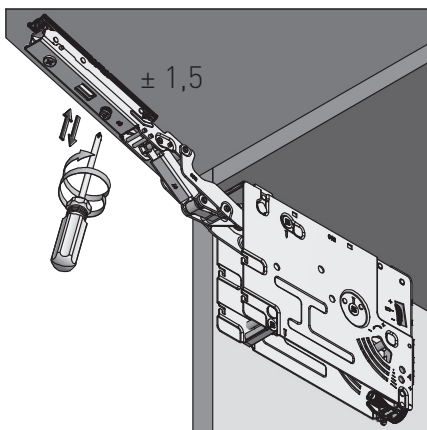

regulace síly otevírání

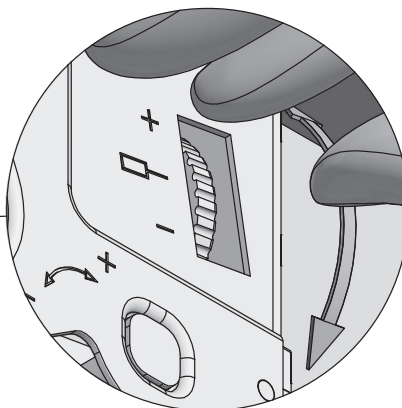
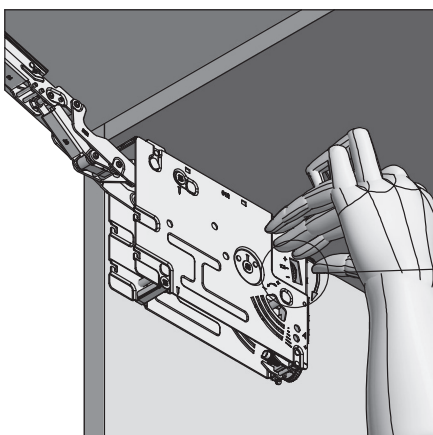

regulace času zavírání

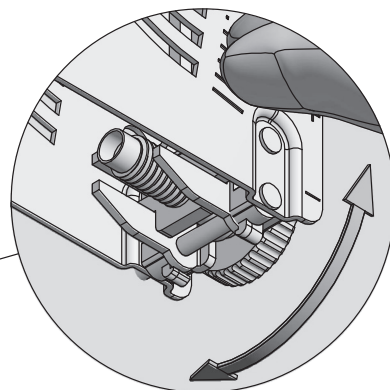
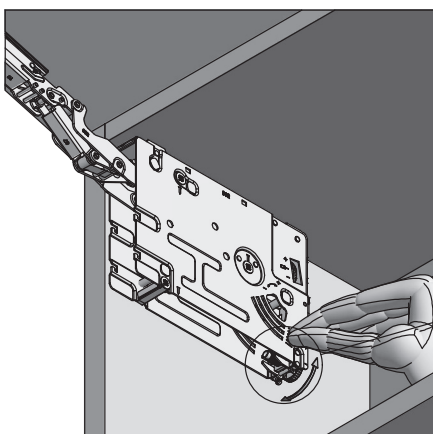

**POZOR!**  
regulace pto úhel 90-107 stupňů  
pro úhel otevíření 80 stupňů použijte omezovač  
úhlu otevíření

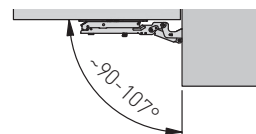

regulace úhlu otevíření



# MONTÁŽ OMEZOVAČE ÚHLU OTEVÍRÁNÍ

